

SINGLE GATE LATCH

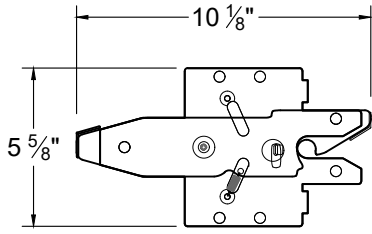

SINGLE GATE STRIKER

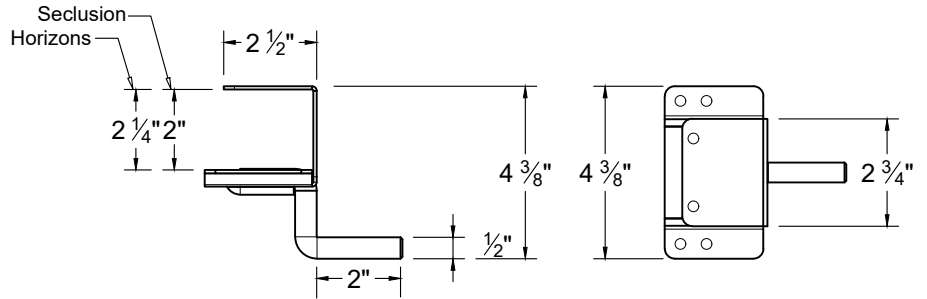

DOUBLE GATE LATCH

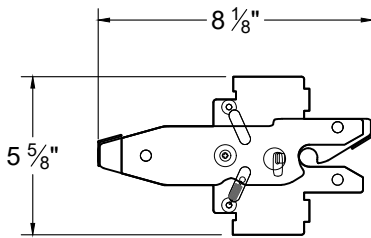

DOUBLE GATE STRIKER

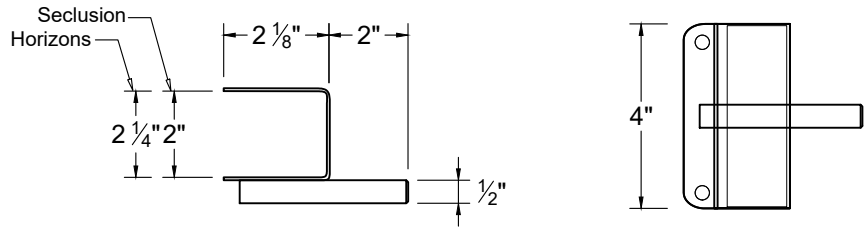

GALVANIZED STEEL GATE POST STIFFENER

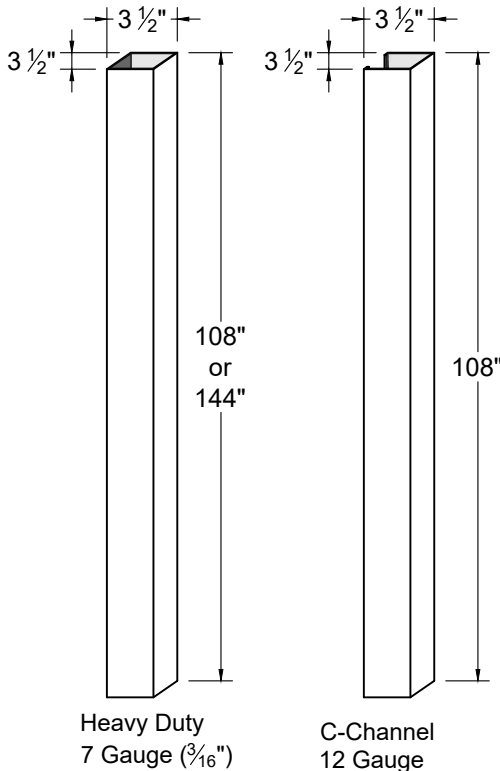

ADJUSTABLE HINGE

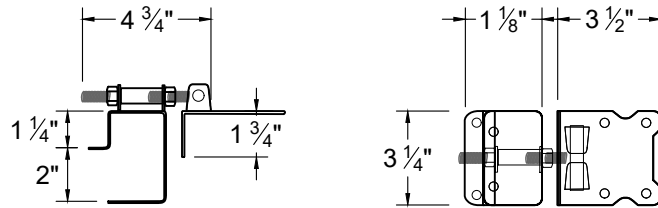

DROP ROD ASSEMBLY

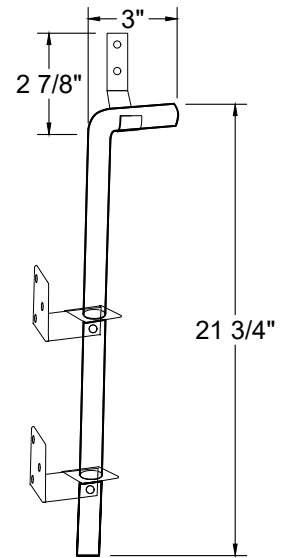

OPTIONAL: ANTI-SAG CABLE KIT

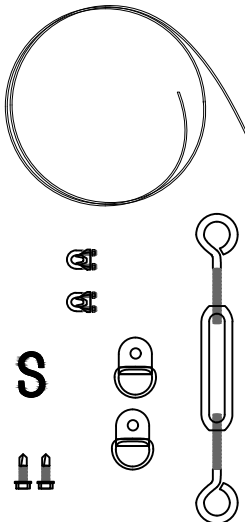

GATE HANDLE

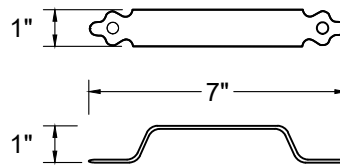

NOTES:

1. ALL TREX GATE HARDWARE IS BLACK POWDER COATED STAINLESS STEEL.
2. #14 SELF-DRILLING SCREWS ARE INCLUDED WITH HARDWARE.
3. INSTALLATION TO BE COMPLETED PER MANUFACTURER'S SPECIFICATION.
4. REFER TO TrexFencingFDS.com FOR CONSTRUCTION DETAILS AND PRODUCT INFORMATION
3. DRAWING NOT TO SCALE.